

TOLERANZEN SZ - ZWEISÄULENGESTELLE ZENTRAL

TOLERANCES SZ - TWO-PILLAR DIE SETS, CENTRAL GUIDING

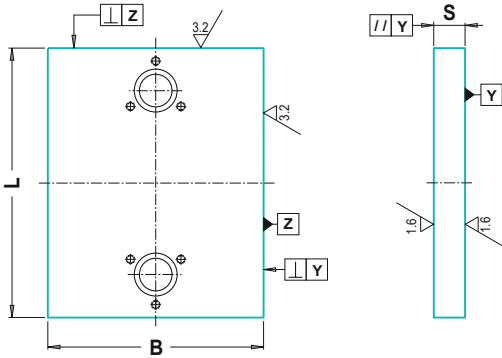

B / L	B / L	SZ
	≤ 496	+0,10 0
	≤ 996	+0,20 0
> 996	+0,30 0	

S	B / L	P ..
	≤ 496	+0,25 +0,20
	> 496	+0,35 +0,30

SZ	
\parallel / Y	0,006 / 100
$\perp Y$	0,04 / 100
$\perp Z$	0,04 / 100

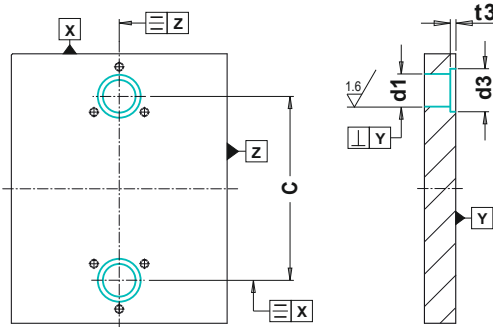

C	L	SZ	SZ 40	
	≤ 496	+0,005 -0,005	d3	+0,1 -0,1
	> 496	+0,01 -0,01	t3	+0,1 0

d1	SZ 80	SZ 40
	+0,010 +0,003	+0,007 +0,000

	B / L	SZ .. ¹⁾
	$\equiv X$	0,10
	$\perp Y$	0,005 / 100
	$\equiv Z$	≤ 296 0,016 ≤ 496 0,020 > 496 0,024

1) SZ 40/80: Ausrichtkante / SZ 40/80: Alignment edge

SPANNUNGSARM GEGLÜHT

STRESS-RELIEVING HEAT-TREATMENT

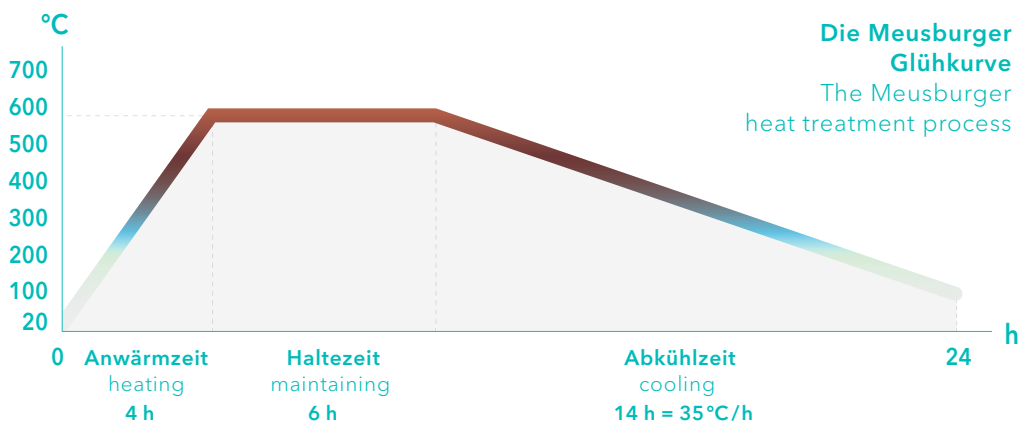

**Die Meusburger
Glühkurve**
The Meusburger
heat treatment process